

# **E-GUIDE FOR 8TH GRADE STUDENTS**

## **CHOOSING A SCHOOL**



### **RECRUITMENT PREPARATION**



**A practical guide for  
students and parents  
for 2026/2027**

Author: **Agata Chudzikiewicz**  
English version: **Marta Tarnowska**

# 10 TIPS

## CHOOSING A SCHOOL

### RECRUITMENT PREPARATION



**Dear Parents! Dear Students!**

Soon our eighth graders will face one of the most difficult choices related to their future - choosing their dream school. The educational market, as every year, offers new classes, extensions or professions. In order to make a good choice, it is important to prepare well for it: on one hand, look at your resources, abilities and predispositions, and on the other hand, take into account what is currently happening in the education and labor market.

The following e-guide was created to help you Dear Student and you Dear Parents in making educational and professional decisions for your children. Here you will find 10 tips to consider when preparing to choose a secondary school.

The guide refers in particular to the educational offer of Kraków schools, but can also be of help to students of schools from Małopolska and the whole country.

**Agata Chudzikiewicz**

**Prepared by:** Agata Chudzikiewicz, Specialized Psychological and Pedagogical Counseling Center of Krakow Career Center

**Substantive consultation:** Tomasz Zemanek, Department of Education of the City of Cracow

# 10 TIPS



## Table of contents:

<b>#TIP 1 - Identify your assets .....</b>	<b>p.3</b>
<b>#TIP 2 - Get help from specialists .....</b>	<b>p.4</b>
<b>#TIP 3 - Estimate your points.....</b>	<b>p.5-6</b>
<b>#TIP 4 - Choose the type of school.....</b>	<b>p.7-11</b>
<b>#TIP 5 - Think about what's most important to you .....</b>	<b>p.12-13</b>
<b>#TIP 6 - Know the rules of this year's recruitment .....</b>	<b>p.14-22</b>
<b>#TIP 7 - If you're considering high school - think about subject extensions .....</b>	<b>p.22-23</b>
<b>#TIP 8 - Learn about the job market and professions .....</b>	<b>p.24-27</b>
<b>#TIP 9 - Learn from your mistakes.....</b>	<b>p.28</b>
<b>#TIP 10 - Students from SPE <i>By: Joanna Turek; SPPP KOK</i> .....</b>	<b>p.29-32</b>



# TIP 1

## IDENTIFY YOUR ASSETS



When choosing a school and profession, we should take into account our internal (personal) and external resources:

- interests,
- skills and abilities (mathematical, linguistic, literary, interpersonal, artistic, musical, sports)
- professional predispositions
- character and temperament
- values
- state of health
- educational paths, the world of professions and the world of work



One helpful tool for determining one's aptitude is a free online test: the **PROFESSIONOMETER**. It is a "Test of vocational interests and aptitudes"; it measures the level of five types of vocational interests and aptitudes, and suggests which professions and types of schools match individual talents. The Professionometer is designed for students graduating from elementary school:



**Start the test**



# TIP 2

GET HELP FROM  
SPECIALISTS



If you are having trouble identifying your resources or need information or support, get help from a career counselor at your school or at the nearest psychological and educational counseling center.

Addresses of psychological and pedagogical  
counselling centres in Kraków: [HERE](#)  
Addresses of counselling centres in the  
Małopolska region: [HERE](#)

A counseling center that specializes in career counseling in Kraków is  
the Kraków Career Center:

Nie wiesz jaką  
**szkołę** wybrać?

Nie wiesz jak określić swoje  
**predyspozycje i mocne strony?**

Potrzebujesz **informacji** na temat  
szkół ponadpodstawowych lub studiów?

Czujesz się zagubiony w ofertach  
rynku edukacji?

Spotkaj się  
z doradcą  
zawodowym:  
**12 632-87-73**

[www.poradniakrakow.com.pl](http://www.poradniakrakow.com.pl)

SPECJALISTYCZNA PORADNIA  
PSYCHOLOGICZNO-PEDAGOGICZNA  
**KRAKOWSKI  
OŚRODEK KARIERY**

f

KIERUNEK PRZYSZŁOŚĆI  
WSPÓŁPRACUJEMY KARIERY UCZNIOWI

# TIP 3

## ESTIMATE YOUR POINTS



Recalculate your points, which will count for recruitment. At this point, take into account the results of the mock exams.

For secondary schools we take into account:

- **8th grade exam** scores - **max 100 pts**
- **Activity** on behalf of other people - **3 pts**
- **Certificate with honors** (so-called belt) - **7 pts**
- **Special achievements** (competitions, Olympiads) - **max 18 pts**

**4 subjects: Polish language, mathematics and two selected educational classes. Grades from these subjects are converted into the following points:**

- ☐ **excellent** – **18 pts**
- ☐ **very good** – **17 pts**
- ☐ **good** – **14 pts**
- ☐ **satisfactory** – **8 pts**
- ☐ **passing**– **2 pts**

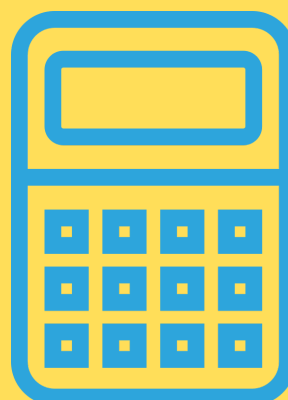



KRYTERIA DLA ABSOLWENTÓW SZKOŁY PODSTAWOWEJ	Maksymalna liczba punktów <sup>1</sup>
<b>Punkty za świadectwo</b>	<b>100 pkt</b>
aktywność na rzecz innych ludzi	3 pkt
świadectwo ukończenia szkoły podstawowej z wyróżnieniem	7 pkt
szczególne osiągnięcia	18 pkt
ocena z języka polskiego (za ocenę celującą)	18 pkt
ocena z matematyki (za ocenę celującą)	18 pkt
ocena z I przedmiotu (za ocenę celującą)	18 pkt
ocena z II przedmiotu (za ocenę celującą)	18 pkt
<b>Punkty za egzamin ósmoklasisty</b>	<b>100 pkt</b>
wynik z języka polskiego	$100\% \times 0,35$ = 35 pkt
wynik z matematyki	$100\% \times 0,35$ = 35 pkt
wynik z języka obcego nowożytnego	$100\% \times 0,3$ = 30 pkt

Of course, we don't know how many recruitment points other students will have this year and which schools they will choose, but comparing results and trends from previous years will allow you to assess your own chances during recruitment with some probability.

To estimate and recalculate how many points you will get in recruitment you can use a calculator.



**Remember!** Different subjects count for each class/school (compulsory Polish and mathematics, in addition to a foreign language and a subject to be determined by the director of the school) hence the number of points for each class/school may differ slightly.

# TIP 4

## CHOOSE THE TYPE OF SCHOOL



Knowing your interests and needs and how many points you can have for recruitment, choose the right type of school.

LO T BS



After completing elementary school, a student can choose the following educational paths:

- **general high school** (baccalaureate) - college
- **general high school** - post-secondary school
- **general high school** - qualification courses
- **technical school** (baccalaureate) - university
- **technical school** - post-secondary school
- **technical school** (baccalaureate) - post-secondary school - university
- **technical school** - qualification courses
- **vocational school of 1st degree** - vocational school of 2nd degree
- **vocational school of 1st degree** - vocational school of 2nd degree (baccalaureate) - university
- **vocational school of 1st degree** - vocational school of 2nd degree - post-secondary school
- **vocational school of 1st degree** - qualification courses (KKZ)
- **special school preparing for work**





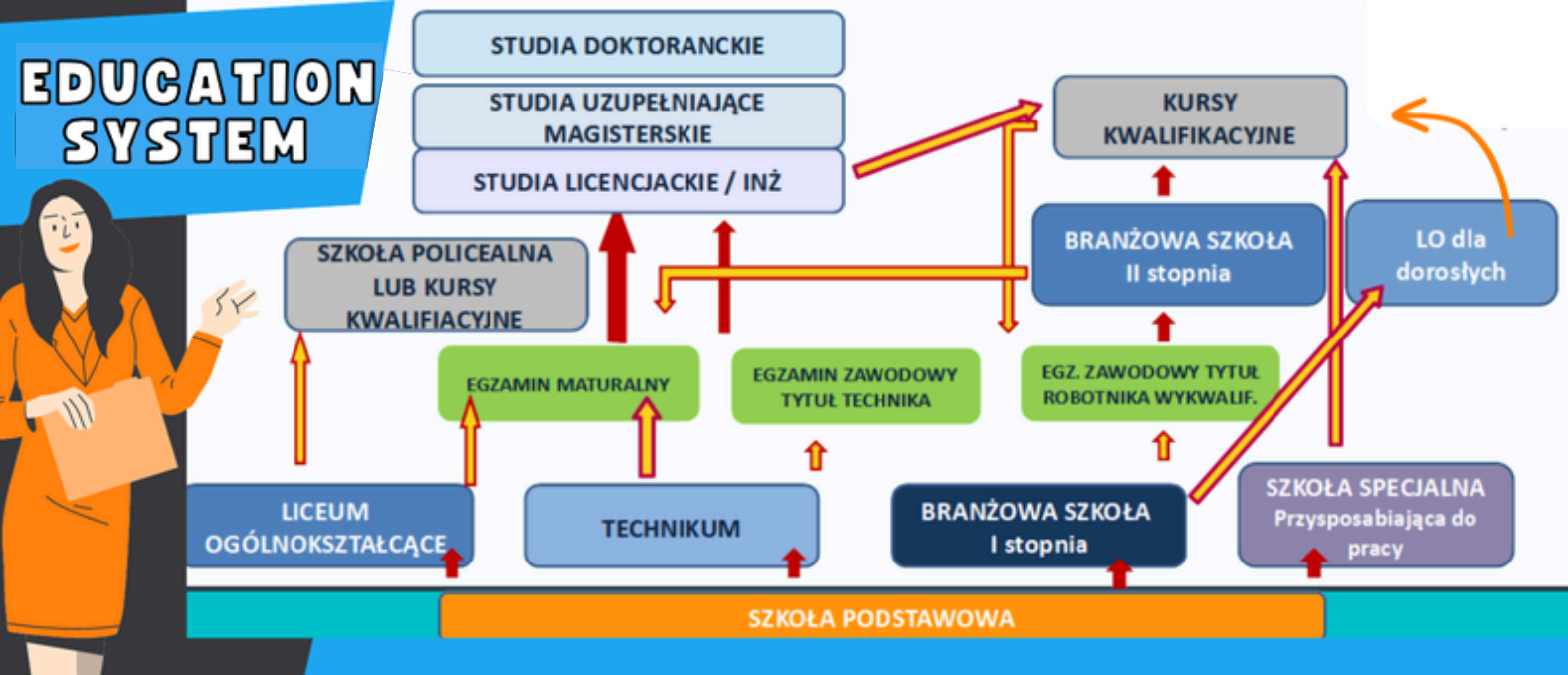

## Characteristics of secondary schools:

### HIGH SCHOOL (LICEUM OGÓLNOKSZTAŁCĄCE):

- education lasts 4 years,
- provides general education,
- an extended program is implemented for several subjects (extended subjects)
- preparation for the matriculation exam (matriculation certificate)

Most often a high school is chosen by an elementary school graduate who has achieved very good or good results in his studies, has a variety of interests, understands the need for constant replenishment of knowledge, is open to changes in the world and associates his future with the completion of higher education.

After passing the high school diploma, the student can choose the following types of studies:

- first-degree studies, which allow you to obtain a higher vocational education. Usually these studies last 3 - 3.5 years. Upon completion, the graduate obtains the professional title of bachelor or engineer;

and then he can continue his studies with a complementary master's degree, lasting 1.5 or 2 years. Upon their completion, the graduate obtains the professional title of master's degree (the field of study of these studies may be different from the field of study of the first degree);

- unified master's studies, which last 5 - 6 years. Upon their completion, the graduate obtains the professional title of Master's degree, entitling him to practice selected professions.

# LO



**Without a high school diploma, you can continue your education in post-secondary schools or vocational courses**

**HIGH SCHOOL - BACCALAUREATE - UNIVERSITY  
HIGH SCHOOL - POST-SECONDARY SCHOOL**





A list of high schools in Kraków is available: [HERE](#)

In addition, the current educational offer for the 2026/2027 school year of each institution will be available directly on the schools' websites and **from 18.05.2026 in the electronic recruitment system.**

#### TECHNICAL SCHOOL (TECHNIKUM):

- education lasts 5 years,
- the school prepares for the baccaureate and vocational exams,
- offers subjects at the extended level,
- the curriculum includes, in addition to general and professional subjects, professional practice,
- allows obtaining a diploma confirming the title of technician in a selected profession after passing professional examinations.

Most often, a technical school is chosen by a graduate who has a clear vocational interest, wants to acquire a profession and perhaps continue his studies in higher education.

After passing the high school diploma, the student can choose the following types of studies:

- First-degree studies, which allow you to obtain a professional degree. Typically, these studies last 3 - 3.5 years. Upon completion, the graduate obtains a professional degree of bachelor or engineer;

and then he can continue his studies with a supplementary master's degree, lasting 1.5 or 2 years. Upon their completion, the graduate obtains the professional title of master's degree (the field of study of these studies may be different from the field of study of the first degree);

- unified master's studies, which last 5 - 6 years. Upon their completion, the graduate obtains the professional title of Master's degree, entitling him to practice selected professions.

# T



**Without a high school diploma, you can continue your education in post-secondary schools or vocational courses.**

**TECHNICAL SCHOOL - BACCALAUREATE - UNIVERSITY  
TECHNICAL SCHOOL – POST-SECONDARY SCHOOL  
TECHNICAL SCHOOL – QUALIFICATION COURSES**



A list of technical schools in Kraków is available: [HERE](#)

In addition, the current educational offer for the 2026/2027 school year of each institution will be available directly on the schools' websites and from 18.05.2026 in the electronic recruitment system.

#### VOCATIONAL SCHOOL 1st GRADE (BRANŻOWA SZKOŁA I STOPNIA):

- study lasts 3 years,
- provides general and professional preparation,
- the curriculum includes practical vocational training, which can take place in school workshops, the Vocational Training Center or at the employer's premises,
- makes it possible to obtain a diploma in a chosen profession after passing professional examinations,
- a graduate of this school can continue education in a general high school for adults,
- a graduate can continue education in an industry school of the second degree (this applies only to selected professions),
- a graduate of this school may also change or supplement his qualifications at qualified vocational courses (Vocational Qualification Courses).

The study period at an industry first-degree school is 3 years, while the study period at an industry second-degree school is 2 years. A vocational qualification course can include a period of study of up to 2 years.

An industry first-degree school is most often chosen by a student who prefers to do a specific job, has practical talents, is already able to perform certain activities related to a related to a specific profession, wants to quickly gain a profession and become independent.

# BS



**1st GRADE VOCATIONAL SCHOOL - 2nd GRADE VOCATIONAL SCHOOL or HIGH SCHOOL for adults**

**1st GRADE VOCATIONAL SCHOOL - QUALIFICATION COURSES**



A list of technical schools in Kraków is available: [HERE](#)

In addition, the current educational offer for the 2026/2027 school year of each institution will be available directly on the schools' websites and **from 18.05.2026 in the electronic recruitment system.**

## SPECIAL SCHOOL

### SPECIAL SCHOOL PREPARATORY TO WORK

- Education lasts 3 years, with the possibility of extending the educational stage by 1 year.
- For students with an evaluation of the need for special education (for students with moderate or severe intellectual disabilities, students with multiple disabilities, including autism).
- Classes: educational, remedial, sports, shaping creativity (including music, art), ethics.
- Graduates receive a certificate confirming adoption for work (without exams).
- After graduating from a special school for adoption to work, you can take up a job or continue your education in adult education institutions.

**Remember!** A certificate from an occupational physician will be necessary to enter a secondary school of the technical school type or an vocational school of the 1st degree. Health plays an important role in choosing a future profession. Hence, you can read more about contraindications to a profession: [HERE](#)



# TIP 5

THINK ABOUT WHAT'S  
MOST IMPORTANT TO YOU



Opinions about the school (teachers, parents, students)

Distance of the school from the place of residence

Prestige of the school

Level of teaching

Appearance of the building

Traditions of the school

Equipment of classrooms

Variability in learning

What percentage of students pass the high school diploma

The school's place in the rankings

Number of "Olympians"

Promotion of the school (website, educational fairs, open days)

Is there a school store/canteen?

Do students go on field trips and where do they go?

What are the extensions/foreign languages at this school?

Are there exchanges and international cooperation?

What are the majors / professions / branches of education at this school?

What is the offer of extracurricular activities, developing and supporting the student?

How do students cope in the labor market afterwards?

Is there a gymnasium?

Are there and what kind of events for students?

**Remember!** What will be called a 'good school' is different for each of us.

## Rankings - what to keep in mind!



Every year the monthly magazine “Perspektywy” presents a ranking of the best schools for the year. Students often ask about rankings.

**Remember!** Such a ranking presents the results of the baccalaureate in compulsory and additional subjects, the success of students in Olympiads, the results of vocational exams in technical schools, while it is not able to fully present how a particular school functions, and does not include parents' or students' opinions about a particular school:

**PROVINCIAL RANKING OF HIGH SCHOOLS 2026 - MAŁOPOLSKA - [HERE](#)**  
**PROVINCIAL RANKING OF TECHNICAL SCHOOLS 2026 - MAŁOPOLSKA - [HERE](#)**

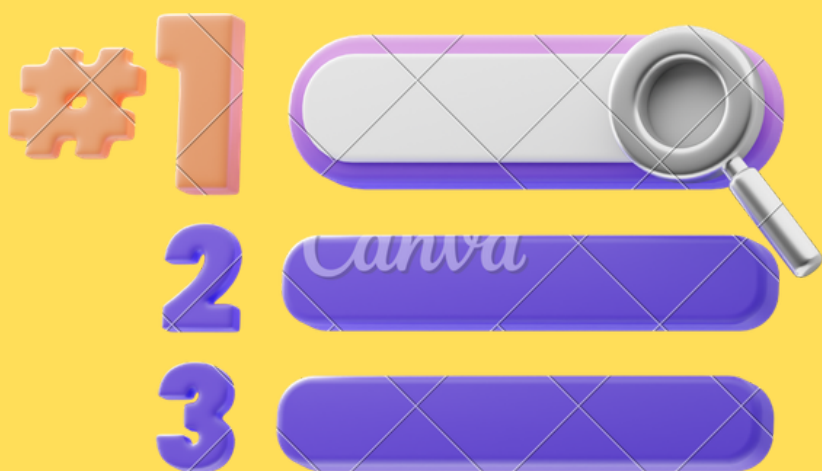

### Reading the table:

To see if a school of interest maintains its level, just look at its ranking positions in previous years - the table presents three consecutive editions.



# TIP 6

## KNOW THE RULES OF THIS YEAR'S RECRUITMENT



Electronic recruitment in Krakow is conducted through the Omikron system

<https://rekrutacje-krakow.pzo.edu.pl>

### What to look for in the recruitment process:

- you can apply for admission to any number of schools/departments/classes included in the recruitment system
- if you apply for admission to a school that is outside the electronic recruitment system, you submit documents directly to the school in question
- you can set your own list of preferences, that is, the order of schools and classes you are interested in
- if you apply for admission to a bilingual class, you will be required to take a test of language competency on the date set by the director of the school in question

- recruitment to sports schools and classes, sports championship schools and uniformed classes also requires taking an additional physical fitness test and providing a certificate from a primary care physician.

- Candidates are qualified for admission to schools after comparing the sum of points calculated on the basis of the results of the eighth-grade exam and the grades and achievements listed on the certificate of completion of elementary school. In the case of an equal number of points, additional criteria are taken into account:

- ✓ candidate's health problems limiting the possibility
- ✓ choice of education direction,
- ✓ multi-children of the candidate's family (a family raising three and more children),
- ✓ disability of the candidate,
- ✓ disability of one or both parents,
- ✓ disability of the candidate's siblings,
- ✓ single parenting of a candidate in a family,
- ✓ inclusion of the candidate in foster care.

- laureates or finalists of national subject olympiads and laureates of provincial or supra-provincial subject competitions, or laureates of competitions for students of schools and art institutions organized by the Minister of Culture and National Heritage or the Center for Artistic Education are admitted to the selected secondary school regardless of the criteria

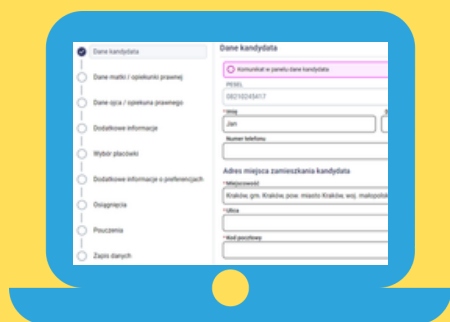

<https://rekrutacje-krakow.pzo.edu.pl>

After typing the above address in the address bar of the browser, a web page will be displayed, through which it will be possible:

- get acquainted with the offer of schools participating in the electronic recruitment (the item Information about the offer) - the panel on the left)

There you will find important information about:

- the location of the school - when you select a specific school, "Clicking" on its name will open the contact details,
- the classes that the school offers with a description, information about the subjects pursued in the extended range,
- the foreign language that can be continued at a particular school,
- subjects taken into account in recruitment, other achievements of the student, which will be taken into account in the calculation of recruitment points. For some schools (or classes), an additional test of language aptitude or a test of physical fitness is required.
- getting acquainted with the recruitment rules and the recruitment schedule (item Recruitment rules, Schedule) - panel on the left-hand side
- filling out the recruitment application - option Register or Login. **ADDITIONALLY this year there is a possibility to log in through the national node (login.gov.pl).**

Strona główna

Zarejestruj

Informator o ofercie

Symulator punktowy

Terminarz

Pliki do pobrania, instrukcja

Zasady rekrutacji

Lista szkół z powiatów

Rejestracja

\*PeSEL dziecka

\*Imię dziecka

\*Nazwisko dziecka

Zarejestruj

LUB

Powrót

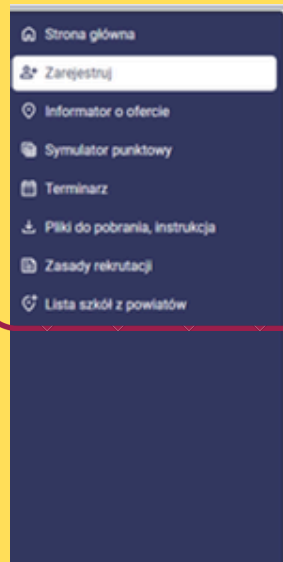

### Rejestracja

\*PeSEL dziecka

\*Imię dziecka

\*Nazwisko dziecka

**Zarejestruj**

LUB

**Powrót**

**Remember!** The candidate, when registering, provides **PESEL number, first name and surname**. After completing the registration, he gives the login and password to his account. With these data he logs into the system.

- ✓ Dane kandydata
- ✓ Dane matki / opiekunki prawnej
- ✓ Dane ojca / opiekuna prawnego
- ✓ Dodatkowe informacje
- ✓ Wybór placówki
- ✓ Dodatkowe informacje o preferencjach
- ✓ Osiągnięcia

Zapis danych

\*Login

\*Hasło

\*Powtórz hasło

**Zarejestruj za pomocą loginu i hasła**

From 18.05.2026 to 8.07.2026 (students recruiting for bilingual, uniform and sports classes **until 1.06.2026**) students fill out an **electronic application**. The recruitment application completed and saved in the recruitment system must be signed by at least one parent or legal guardian of the candidate.



Powiat krakowski lub dzielnica miasta Kraków

Wyszukaj

▼ I Liceum Ogólnokształcące  
PLAC NA GROBLACH 9, 31-101 Kraków Kraków - I Stare Miasto

+ A-ogólnodostępny - matematyka, fizyka, informatyka

+ B-ogólnodostępny - matematyka, fizyka, informatyka

+ C, D, H-ogólnodostępny - matematyka, biologia, chemia

+ E-ogólnodostępny - historia, j. angielski, WOS

+ G-ogólnodostępny - matematyka, geografia, j. angielski

+ K-ogólnodostępny - j. polski, historia, j. łaciński i kultura antyczna

▼ II Liceum Ogólnokształcące  
JANA SOBIESKIEGO 9, 31-136 Kraków Kraków - I Stare Miasto

+ 1A-ogólnodostępny - matematyka, fizyka, informatyka

+ 1B-ogólnodostępny - matematyka, chemia, fizyka

+ 1C-ogólnodostępny - matematyka, biologia, chemia

+ 1D-ogólnodostępny - matematyka, geografia, j. angielski

Potwierdź wybór

**When filling out the application, be sure to provide additional information:**

**Dodatkowe informacje**

☐ Kandydat z problemami zdrowotnymi, ograniczającymi możliwości wyboru kierunku kształcenia ze względu na stan zdrowia.

☐ Wielodzietność rodziny kandydata (oznacza to rodzinę wychowującą troje i więcej dzieci).

☐ Niepełnosprawność kandydata.

☐ Niepełnosprawność jednego z rodziców kandydata.

☐ Niepełnosprawność obojga rodziców kandydata.

☐ Niepełnosprawność rodzeństwa kandydata.

☐ Samotne wychowywanie kandydata w rodzinie.

☐ Objęcie kandydata pieczę zastępczą.

**Important:** In addition to the Krakow schools included in the electronic recruitment system, you can also choose schools from the districts of Kraków, Olkusz, Oświęcim, Wadowice and others.



**Q.: Can I change the order of schools after I deliver the application to my first choice school?**

**A: You can, but you must request in writing to the school of first choice to revoke the confirmation of the application in the recruitment system.**

**Q: What if a student forgets the password to his/her account in the system?**

**A: If a correct email address was entered in the "Parent or student data" panel when filling out the electronic application (which was saved), in the situation of losing the password, the applicant can change it himself. On the system page, select the "Forgot password" option. Enter the candidate's PESEL and the email address provided when filling out the application, then press: "Generate a new password and send to the email address provided". If the student forgot to enter the email, he or she must go to the school of first choice to get the password.**

**If the student fills out the application, but does not click "save" at the end after logging out, his data will be lost.**



#### Logowanie / Rejestracja

\*Login

\*Hasło

Zaloguj się

Zapomniałem hasła

LUB

Zarejestruj

After completing and saving the application, the candidate (after logging in) **has the opportunity to check the status of the application at each stage of recruitment.** It is important for you to **make sure** that the results and achievements entered by your first-choice school have been correctly entered into the system after you have provided the certificate of the results of the eighth-grade exam, the certificate and your achievements.



**Q: What is a “first choice school” ?**

**A: A first-choice school is the school that a student places first on his or her list of schools of choice.**

**Q: Where and how do we deliver the application to the schools?**

**A: First, you need to fill out an electronic application in the Omikron system. The application can be signed with an ePUAP Trusted Profile, a personal signature or a qualified signature. The prerequisite for using this option is to have a Trusted Profile, e-ID or qualified signature. An application that is not signed electronically must be printed out, signed by the student and the parent (legal guardian or person/entity having custody of the candidate) and delivered to the first-choice school (Note: The first-choice school confirms the application in the system and from then on the application is visible in the system for all the schools the student has listed. From now on, the student can no longer edit anything in his application himself).**

**Q: Does the student get into all the schools from his list and can choose a school for himself ?**

**A: No. The student gets into the school to which he meets the points criteria. If he doesn't get into the school he has first on the list, the system will move him lower and so on one by one, until the class to which he meets the point requirements.**

## Schedule:



<b>18.05 – 8.07.2026</b>	Złożenie wniosku o przyjęcie do szkoły (wniosek elektroniczny)
<b>18.05 – 1.06.2026</b>	Złożenie wniosków osób starających się do szkół, gdzie obowiązywać będą sprawdziany uzdolnień kierunkowych, sportowych czy językowych (klasy dwujęzyczne), wojskowych
<b>2.06-30.06.2026</b>	Sprawdziany uzdolnień kierunkowych, sportowych czy językowych
<b>do 2.07.2026</b>	Ogłoszenie list kandydatów, którzy uzyskali pozytywny wynik sprawdzianu lub próby sprawnościowej
<b>26.06 - 8.07.2026</b>	Uzupełnianie wniosku w systemie: oceny ze świadectwa i wyniki egzaminu ósmoklasisty
<b>15.07.2026 do godz.12.00</b>	Ogłoszenie list kandydatów zakwalifikowanych i niezakwalifikowanych
<b>18.05 - 15.07.2026</b>	Wydanie przez szkołę skierowania na badania lekarskie (dotyczy szkół branżowych i techników)
<b>do 17.07.2026 do godz 15.00</b>	Potwierdzenie woli podjęcia nauki w danej szkole (dostarczenie <b>oryginałów</b> świadectwa ukończenia szkoły podstawowej, zaświadczenia o wynikach egzaminu ósmoklasisty, zaświadczenia lekarskiego)
<b>20.07.2026</b>	Ogłoszenie list przyjętych i nieprzyjętych do danej szkoły

## EXAMS SCHEDULE



Special Education  
students may receive  
extended work time

- Polish language - **May 11, 2026** (Monday) - 150 minutes
- Mathematics - **May 12, 2026** (Tuesday) - 125 minutes
- Modern Foreign Language - **May 13, 2026** (Wednesday) - 110 minutes

You can see detailed information on the dates for recruitment to  
secondary schools - [HERE](#)



# TIP 7

THINK ABOUT SUBJECT  
EXTENSIONS IF YOU'RE  
CONSIDERING HIGH SCHOOL



Remember! The choice of extended subjects is related to the choice of subjects passed in the final exam in high school and then the choice of higher education.

High school students are required to choose and pursue at least two, but no more than four, subjects in the extended range. The remaining subjects are taught at the basic level. The rules governing what and how many subjects students must study in the expanded range are set by regulations of the Ministry of Education.

Extensions are important, because for some faculties at university it is required to pass the matriculation exam at an extended level, and it is from it that points are calculated for recruitment. Hence, when choosing an extension, it is worth checking how recruitment looks like in the fields of study you are interested in.



The school may also have other supplementary subjects: economics in practice, art classes or other subjects for which no core curriculum has been established, but the curriculum has been developed at school. The name of the profile most often announces what subjects will be taught in the expanded mode. Here are some examples of class profiles and extended subjects:

**Mathematics and physics class** (so called: mat. - fiz.) - extended: mathematics, physics, English language

**Biological-chemical class** (so called: biol. - chem.) - extended: biology, chemistry, mathematics

**Humanities class** - expanded: Polish, history, language  
English

Some schools offer more unusual class profiles, and that's why you should definitely check what's behind these names when it comes to about extended subjects. Such profiles and classes are, for example:

- Linguistic-legal profile - expanded: English, history, knowledge of society (WOS)
- Public security profile - expanded: geography, knowledge of society (WOS), mathematics
- Historical-legal class - expanded: Polish language, history, selective: WOS, English language
- Linguistic class with tourist profile - expanded: language
- English, Spanish or German language, geography
- European class - expanded: English language, geography, knowledge of society (WOS)

Extensions do not necessarily have to be related to the profile of the class. If students are interested in learning some subjects in the extended range (because, for example, they need it for their high school diploma), and the school can offer such extensions, they can implement it in smaller groups - separated from part of the class or interclass groups, in the first and last lessons .



# TIP 8

LEARN ABOUT THE JOB MARKET  
AND THE PROFESSIONS YOU  
CAN TRAIN IN



If you're thinking of going to a technical school or vocational school, get caught up on current occupational industries, information on professional qualifications and an occupational barometer for your region.

## Industries in alphabetical order:

- branża audiowizualna (AUD),
- branża budowlana (BUD),
- branża ceramiczno-szklarska (CES),
- branża chemiczna i ochrony środowiska (CHM),
- branża drzewno-mieblarska (DRM),
- branża ekonomiczno-administracyjna (EKA),
- branża elektroenergetyczna (ELE),
- branża elektroniczno-mechatroniczna (ELM),
- branża fryzjersko-kosmetyczna (FRK),
- branża górniczo-wiertnicza (GIW),
- branża handlowa (HAN),
- branża hotelarsko-gastronomiczno-turystyczna (HGT),
- branża leśna (LES),
- branża mechaniczna (MEC),
- branża mechaniki precyzyjnej (MEP),
- branża metalurgiczna (MTL),
- branża motoryzacyjna (MOT),
- branża ochrony i bezpieczeństwa osób i mienia (BPO),
- branża ogrodnicza (OGR),
- branża opieki zdrowotnej (MED),
- branża poligraficzno-księgarska (PGF),
- branża pomocy społecznej (SPO),
- branża przemysłu mody (MOD),
- branża rolno-hodowlana (ROL),
- branża rybicka (RYB),
- branża spedycyjno-logistyczna (SPL),
- branża spożywcza (SPC),
- branża teleinformatyczna (INF),
- branża transportu drogowego (TDR),
- branża transportu kolejowego (TKO),
- branża transportu lotniczego (TLO),
- branża transportu wodnego (TWO).



Since 2019, the new structure of the classification of vocational education occupations takes into account the assignment of individual occupations to one of 32 industries, taking into account the specificity of vocational skills or the extent to which these skills are used in the performance of professional tasks.

## Vocational qualifications:

The professions have distinguished and named qualifications, which are confirmed through external professional examinations.

A **vocational qualification** is a body of knowledge and a range of skills that allows one to independently perform a specific task or set of **vocational tasks** and enable one to work.

Occupations are divided into single-qualification and dual-qualification.

At an industry school of the first degree, a student is educated in a single qualification. Upon completion of the school, the student obtains an industry qualification and a certificate confirming the qualification distinguished in the profession and receives a diploma confirming professional qualifications.

Second-degree trade schools function in professions that have a continuation at the technical level. After graduating from an industry first-degree school and obtaining a qualification in the first qualification, a student may continue his education in an industry second-degree school. After graduating from an industry second-degree school and passing the examination for the second qualification, the graduate obtains an industry secondary education and a certificate confirming the qualifications in the profession and receives a diploma confirming professional qualifications. After passing the high school diploma, the student can continue his studies at university.

Among the professions in which training is provided at the technical school, dual-qualification professions predominate. After graduating from a technical school and passing the baccalaureate, a student can continue his studies at university.



**Przykład:**

W zawodzie **ELEKTRYK** wyodrębniono jedną kwalifikację:

- I. Montaż, uruchamianie i konserwacja instalacji, maszyn i urządzeń elektrycznych

W zawodzie **TECHNIK ELEKTRYK** wyodrębniono dwie kwalifikacje:

- I. Montaż, uruchamianie i konserwacja maszyn i urządzeń elektrycznych
- II. Eksploatacja maszyn, urządzeń i instalacji elektrycznych



Every year there are many new professions in vocational education. The Ministry of Education signs the relevant regulations on this issue for the year. The introduction of **new professions** to the classification is the MEN's response to the needs of the labor market. If you want to know what the changes are for the coming year you can read about it - [HERE](#).

Monitoring of occupations is also a study carried out by the Ministry of Family, Labor and Social Policy and provincial and district labor offices throughout Poland. Every year, a so-called **Occupation Barometer** is created, which is a one-year forecast of the situation in occupations. The barometer divides occupations into three groups: shortage occupations, in which there is a shortage of workers; balanced occupations, in which the number of workers meets the needs of employers; surplus occupations, in which there are more workers than job offers. To read this year's barometer in the Małopolska province click - [HERE](#).





Career Map is a portal where you can find descriptions of more than 700 professions – [HERE](#). Alongside the description of a given profession are: requirements and skills; a sample educational path - how to get this profession, the demand for this profession and even earnings.

Mapa Karier

Ścieżki kariery Miasto zawodów Młodzież Nauczyciel Rodzic 0 nas 1.5%

**DZIŚ ODKRYWAJ, JUTRO WYBIERAJ**

**MIASTO ZAWODÓW**  
Dla najmłodszych odkrywców

**ŚCIEŻKI KARIERY**  
Dla planujących karierę

**STREFA NAUCZYCIELA**  
Poprowadź angażujące zajęcia o rynku pracy i świecie zawodów.  
**WEJDŹ**

**STREFA MŁODZIEŻY**  
Sprawdź, co możesz robić w przyszłości.  
**WEJDŹ**

**STREFA RODZICA**  
Wesprzyj dziecko i nastolatka w wyborach edukacyjnych i karierowych.  
**WEJDŹ**

Bezpłatna, interaktywna baza informacji o ścieżkach kariery i rynku pracy

Mapa Karier

Ścieżki kariery Miasto zawodów Pomysły na lekcje Blog Współpraca FAQ

**Ścieżki kariery**  
Wyników: 620

**ZMIEN PŁEĆ** **SORTOWANIE** **FILTROWANIE**

 Inżynier audiowizualny	 Pielęgniarka opieki długoterminowej	 Zawód przyszłości Cyfrowy krawiec	 Zakonnik
 Przedstawiciel medyczny	 Zawód przyszłości Biolog molekularny	 Balsamista	 Specjalista ds. e-commerce



# TIP 9

## LEARN FROM YOUR MISTAKES



You can learn from your mistakes, but also from the mistakes of others. Think about this before you make a decision and choose a secondary school.

When choosing a secondary school **DON'T CHOOSE IT BECAUSE:**

- your best friend/colleague is going there - what is good for your friend/colleague is not necessarily good for you
- your parents “tell me to” - parents are very important advisors in our lives, but the choice of school and our professional future must be in accordance with our interests, aptitudes and abilities
- of the fact that there is already little time and you have to choose “whatever” - haste is not the best advisor
- of the fact that you don't know anything about the school, but the professions from the school are “on top”
- of ignorance of your health contraindications - if you have certain limitations, difficulties or health challenges take them into account, because we spend a good part of our lives at work

# TIP 10

## STUDENTS FROM SPE



If you are a student with individual or special needs, consider your life or health situation in choosing further education. See what the education market has in store for you.

Students with special educational needs are entitled to:

- **exemption from the obligation to take the exam**
  - in case of combined disabilities
  - in special cases of fate or health
- **adaptation of the exam form**
  - for students with a certificate of special education needs (due to disability)
  - for citizens of another country (including Ukraine)
  - for students with color vision disorders
- **adaptation of exam conditions**
  - for students with a certificate on the need for special education/ individual teaching
  - for students with an opinion on specific learning difficulties
  - for students covered by psychological and pedagogical assistance
  - for students with chronic diseases
  - for citizens of another country
  - for students in a difficult, crisis situation



## Q: What is this exemption all about?

Students with a special education certificate issued for more than one disability do not have to (although they can!) take the exam.

The District Examination Commission may also, on the basis of a doctor's certificate, exempt before the main session a student whose health makes it impossible to take the exam (serious illness), or even already after the main session when a fortuitous event or sudden illness has interrupted the exam and the student will not be able to write on the second date.



## Q: What about points then?

Points are converted based on the grades obtained at the end of the eighth grade:

### from Polish language and mathematics:

excellent - 35 points  
very good - 30 points  
good - 25 points  
sufficient - 15 points  
acceptable - 10 points

### from a modern foreign language:

excellent - 30 points  
very good - 25 points  
good - 20 points  
sufficient - 10 points  
acceptable - 5 points



### Q: What is a form adaptation?



It is simply a prepared separate sheet, adapted to the needs and abilities of students with disabilities or foreigners.

Instructions can be written in a larger font, in simplified form, in shades of gray or in a foreign language.

### Q: What is an adaptation of conditions?

The idea is that students who need it can write the exam under conditions that meet their special educational needs ie:

- they had sufficiently more time to write
- did not have to transfer their answers to a separate sheet
- were provided with a place, including in a separate room
- could use the necessary equipment
- they could use a computer (dysgraphia)
- were allowed to use a calculator (dyscalculia)
- a literacy support teacher or specialist was present during the exam
- grading criteria were applied taking into account their needs and abilities

**Remember!** To apply any of the of the adaptations, the student must have a document that entitles him/her to do so (e.g., a ruling/opinion) with specific provisions. In some cases, it is necessary that a particular type of support has already been applied at school.



[Detailed information on adjustments with sample sheets, sample applications and deadlines for submission: HERE](#)



Students with special educational needs also have the right to study in inclusive or special classes. Recruitment to these classes is usually carried out bypassing the OMIKRON system. The condition for admission is the possession of a current special education certificate - depending on your needs, you can study in, for example:

- integration class of high school (to integration classes, students with an evaluation of the need for special education are admitted on the basis of a referral, and not as a result of recruitment)
- industry special school of the first and second degree
- special school preparing for work

Information on inclusive and special schools and facilities: [HERE](#)

**Eighth graders!**  
**Planning your future is not easy**  
**but remember you are not alone with these**  
**choices!**



**"If you can dream it, you can do it"**  
**- Walt Disney**